

## Notes:

- Maximum Electric Current: 

AWG	12	10	
AMP	35	50	
- Maximum Electric Rating: 105°C 600 Volts Max
- Insulation Material: Vinyl
- Insulation Color: Yellow
- Terminal Material: Copper
- Wire Range: 12-10 AWG (4-6mm<sup>2</sup>)
- Terminal Surface Treatment: Tin Plated
- Terminal Thickness: 1.00mm

### Standard (Metric)

1.06" (26.8mm)  
 0.36" (9.15mm)  
 0.51" (13mm)  
 0.37" (9.5mm)  
 0.17" (4.3mm)  
 0.13" (3.4mm)  
 0.25" (6.4mm)

### Tolerances

(Unless Otherwise Specified)

**CATEGORY**

Vinyl Insulated  
Hook Terminals

**SCALE**

4/1

**PART #**

HVB5-4

**SHEET**

1-4

**MATERIAL**

Tin-Plated Copper

**PAGE**

10F2

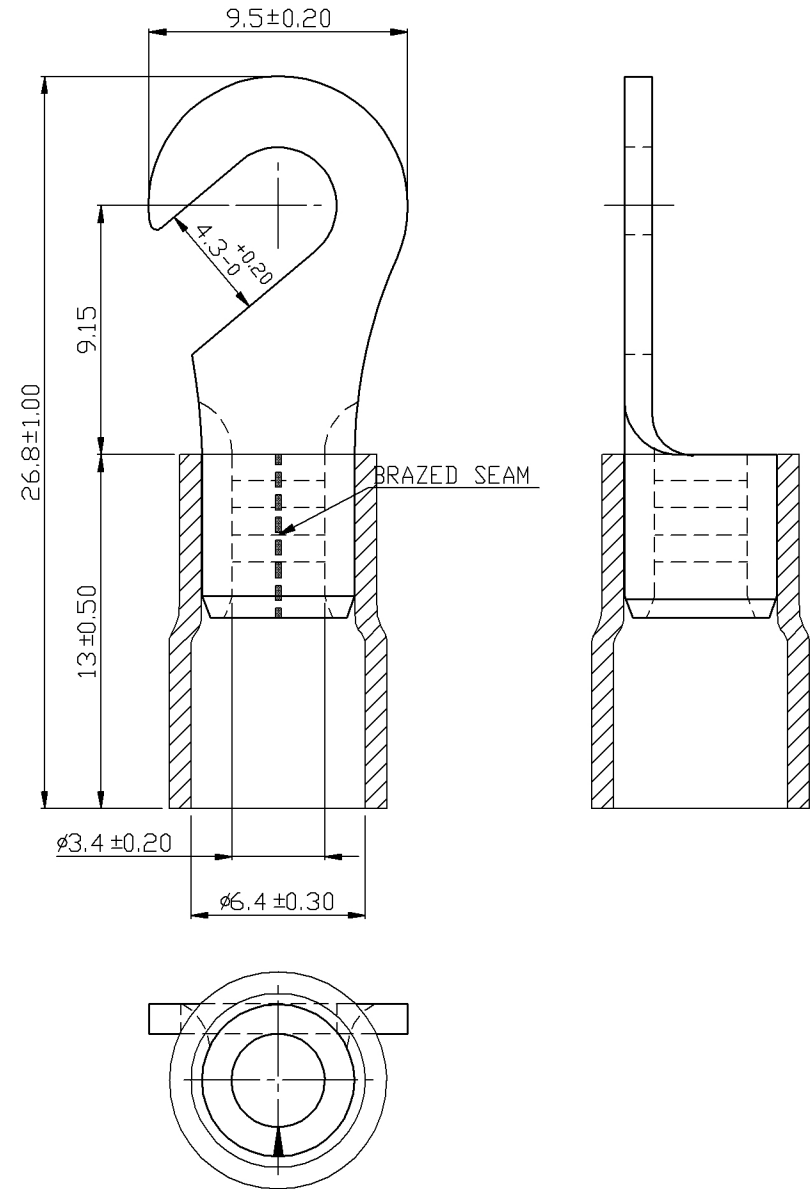

**MIROMAR**