

## Notes:

- Maximum Electric Current: 

|     |    |    |  |  |
|-----|----|----|--|--|
| AWG | 12 | 10 |  |  |
| AMP | 20 | 24 |  |  |
- Maximum Electric Rating: 105°C 600 Volts Max
- Insulation Material: Nylon
- Insulation Color: Yellow
- Terminal Material: Brass
- Wire Range: 12-10 AWG (4-6mm<sup>2</sup>)
- Double Crimp
- Terminal Surface Treatment: Tin Plated
- Terminal Thickness: 0.40mm
- Nema Tab: 0.032 inch x 0.250 inch (0.8mm x 6.35mm)

### Standard (Metric)

0.93" (23.5mm)  
 0.51" (13mm)  
 0.30" (7.5mm)  
 0.26" (6.6mm)  
 0.13" (3.4mm)  
 0.26" (6.5mm)

### Tolerances

(Unless Otherwise Specified)

0 > 6mm ± 0.20  
 6 > 18mm ± 0.30  
 18 > 30mm ± 0.40  
 30 > 75mm ± 0.50

|                 |   |              |      |
|-----------------|---|--------------|------|
| <b>CATEGORY</b> | Nylon Insulated Double Crimp Female Disconnectors | <b>SCALE</b> | 4/1  |
| <b>PART #</b>   | FDNYD5-250  | <b>SHEET</b> | 1-0  |
| <b>MATERIAL</b> | Tin-Plated Brass                                  | <b>PAGE</b>  | 10F2 |

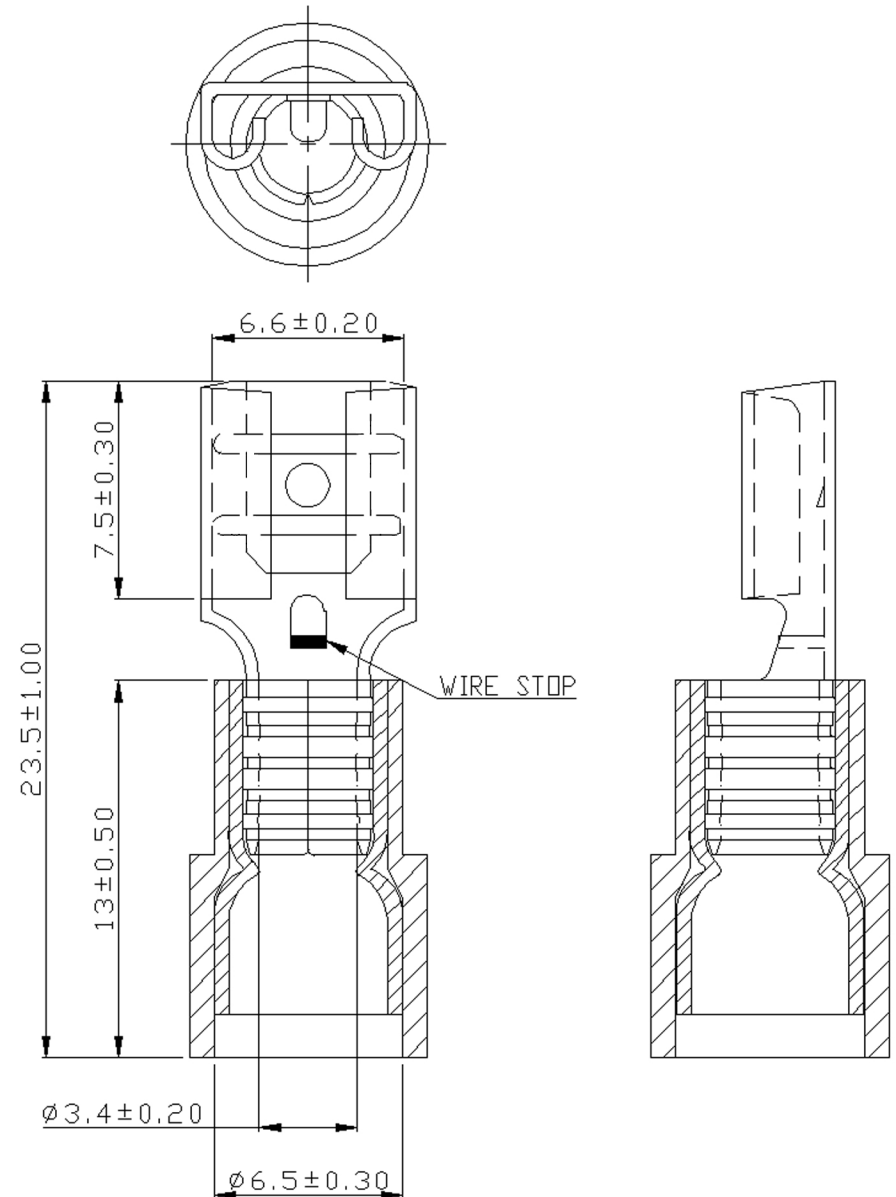

# MIROMAR