

## Notes:

- Maximum Electric Current: 

AWG	22	20	18	16
AMP	3	4	7	10
- Maximum Electrical Rating: 105° 600 Volts Max.
- Insulation Material: Nylon
- Insulation Color: Red
- Terminal Material: Brass
- Wire Range: 22-16 AWG (0.5-1.5mm<sup>2</sup>)
- Terminal Surface Treatment: Tin Plated
- Nema Tab: 0.032" x 0.250" (0.8mm x 6.35mm)
- Double Crimp
- Terminal Thickness: 0.40mm

### Standard (Metric)

0.85" (21.5mm)  
 0.43" (11mm)  
 0.30" (7.5mm)  
 0.26" (6.6mm)  
 0.07" (1.7mm)  
 0.16" (4mm)

### Tolerances

(Unless Otherwise Specified)

0 > 6mm ± 0.20  
 6 > 18mm ± 0.30  
 18 > 30mm ± 0.40  
 30 > 75mm ± 0.50

CATEGORY	Female Nylon Insulated Double Crimp Disconnects	SCALE	4/1
PART #	DFNYD1-250	SHEET	1-0
MATERIAL	Tin-Plated Brass	PAGE	10F2

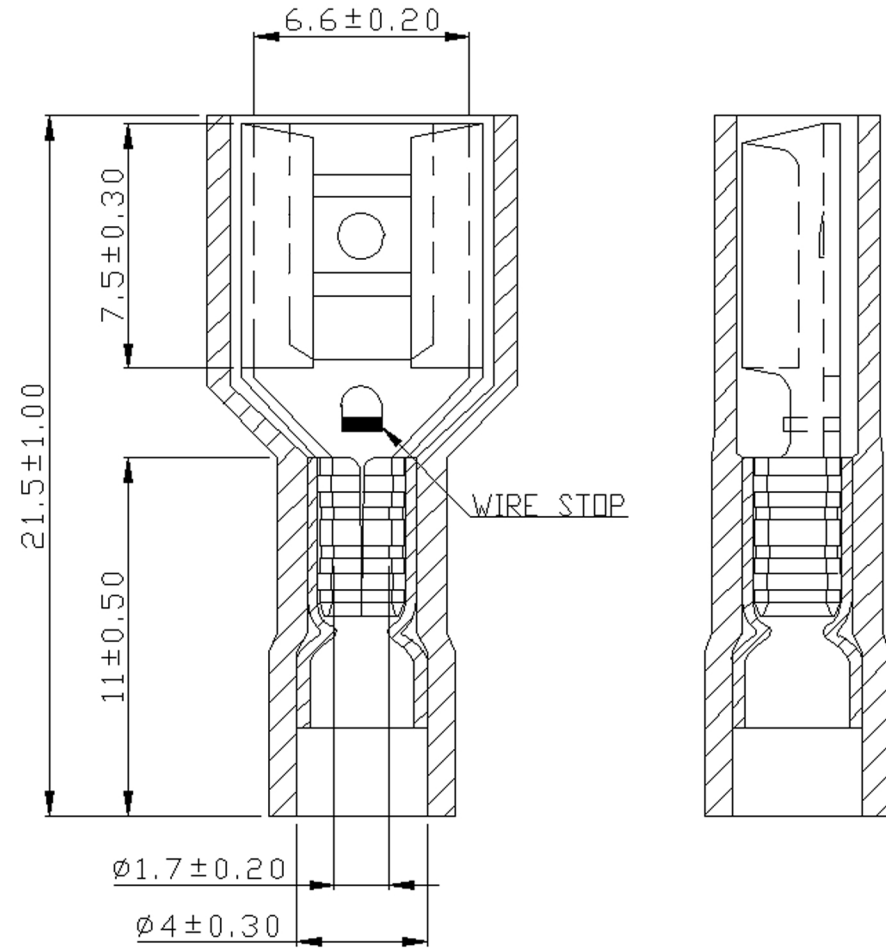

# MIROMAR