

## Notes:

- Maximum Electrical Current: 

AWG	12	10	
AMP	35	50	
- Maximum Electrical Rating: 75° 600 Volts Max.
- Insulation Material: Vinyl
- Insulation Color: Yellow
- Terminal Material: Copper
- Wire Range: 12-10 AWG (4-6mm<sup>2</sup>)
- Terminal Surface Treatment: Tin Plated

### Standard (Metric)

1.04" (26.5mm)  
0.13" (3.4mm)  
0.25" (6.3mm)

### Tolerances

(Unless Otherwise Specified)

0 > 6mm ± 0.20  
6 > 18mm ± 0.30  
18 > 30mm ± 0.40  
30 > 75mm ± 0.50

<b>CATEGORY</b>	Vinyl Insulated Flared Butt Splice Connector	<b>SCALE</b>	4/1
<b>PART #</b>	BV5	<b>SHEET</b>	1-0
<b>MATERIAL</b>	Tin Plated Copper	<b>PAGE</b>	10F2

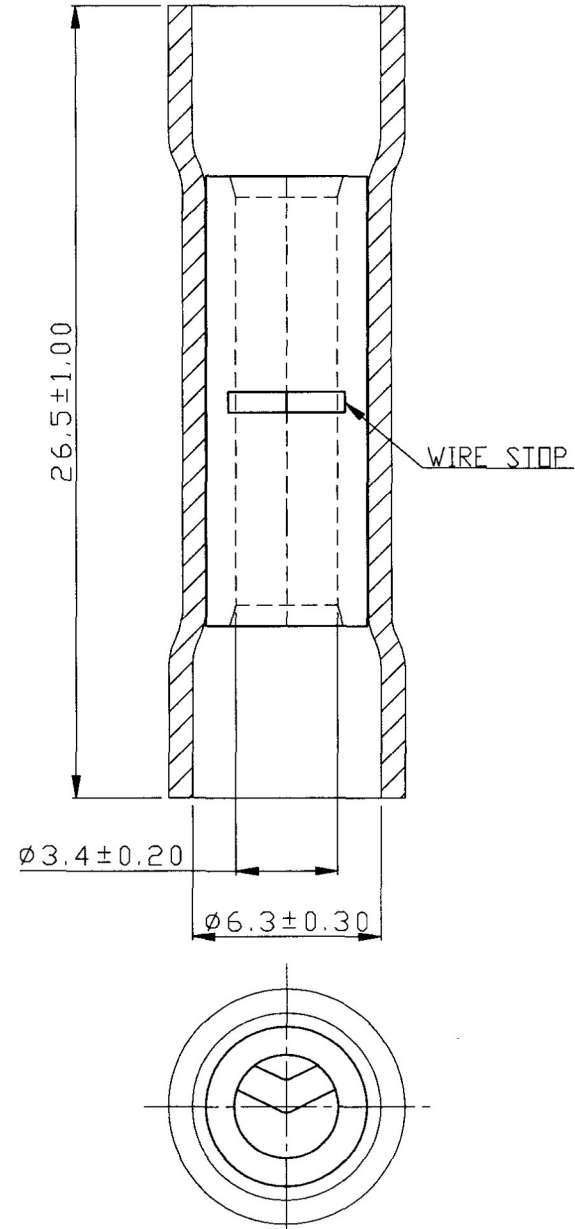

# MIROMAR