

Notes:

- Maximum Electrical Current:

AWG	22	20	18
AMP	3	4	7
- Maximum Electrical Rating: 105° 600 Volts Max.
- Insulation Material: Nylon
- Insulation Color: Red
- Terminal Material: Brass
- Wire Range: 22-18 AWG (0.5-0.75mm²)
- Terminal Thickness: 0.8mm
- Terminal Surface Treatment: Tin Plated
- Suggested Mate with Male Tab (Thickness x Width):
MDFNY1-250 (0.032 x 0.250)

Standard (Metric)

1.46" (37mm)
0.39" (9.8mm)
0.02" (0.5mm)

Tolerances

(Unless Otherwise Specified)

0 > 6mm ± 0.20
6 > 18mm ± 0.30
18 > 30mm ± 0.40
30 > 75mm ± 0.50

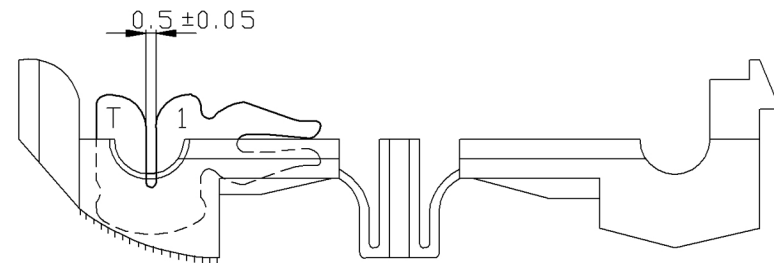
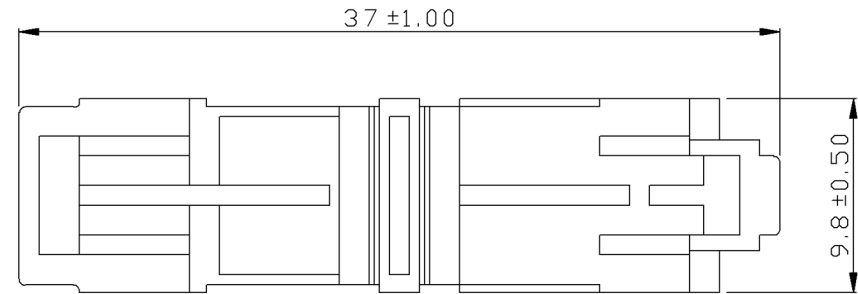

CATEGORY	Quick Splice Connector	SCALE	3/1
PART #	878006	SHEET	1-2
MATERIAL	Tin Plated Brass	PAGE	10F1



MIROMAR